

\* 3 1/2" MINIMUM SLAB THICKNESS REQUIRED.

\* MONOLITHIC SLABS ARE NOT PERMITTED FOR HABITABLE SPACE OR FOR BUILDINGS WHICH WILL BE ATTACHED TO ANOTHER BUILDING WITH HABITABLE SPACE.

\* FIBER MESH CONCRETE IS PERMITTED. HOWEVER, IT IS NOT PERMITTED TO SUBSTITUTE FOR THE WIRE MESH.

\* ALL REINFORCEMENT MUST HAVE A MINIMUM OF 1 1/2" CONCRETE COVER.

BOTTOM PLATE SHALL BE PRESSURE TREATED OR FOUNDATION REDWOOD.

LAP SIDING OVER FOUNDATION A MIN. OF 1"

1/2" DIAMETER STEEL ANCHOR BOLTS INSTALLED 6'-0" ON CENTER OR LESS. BOLTS MUST BE EMBEDDED A MINIMUM OF 7" INTO CONCRETE.

#4 REBAR TOP & BOTTOM

6" X 6" WELDED WIRE MESH THROUGHOUT ENTIRE SLAB

LEVEL OF GRADE

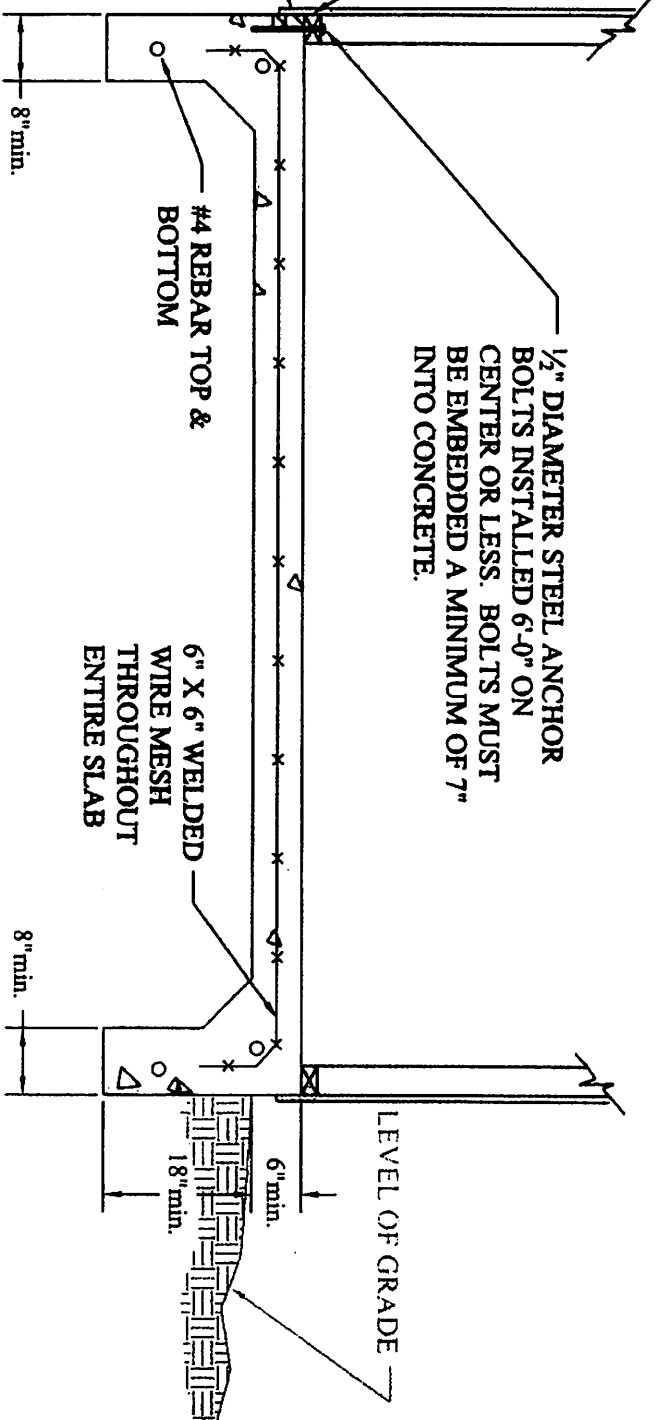

# Monolithic Slab Detail